

TII 97C

ADSL2+ POTS Splitter Module

Compatible with the
TII 3600/3700/763 and
CAC 7600

Circuit Approved by Calix,
IOL for ADSL2+, IPTV
Deployment

Meets IPTV Ring Trip
Saturation Current
Requirements

Provides Network Test
Signature

Listed to UL 1863

 **TII**
network
technologies, inc.

1385 AKRON STREET
COPIAGUE, NY 11726
(631) 789-5000
FAX: (631) 789-5063

CUSTOMER SERVICE
(888) 844-4720 TOLL FREE
(631) 789-5020
FAX: (631) 789-5063
customerservice@tiinettech.com

www.tiinettech.com



TII 97C-1-1-2

The TII 97C ADSL2+ POTS Splitter Module is a passive device which splits the combined voice and data signal carried on telephone lines to provide separate outputs for both phone and data services.

KEY PRODUCT BENEFITS

- Designed for use at the subscriber premises in a Network Interface Device (NID).
- Device can be mounted in a wide variety of Corning Cable Systems NI-2000 compatible NIDs.
- May be installed adjacent to existing Corning PTD (Protected Termination Device).
- Asymmetrical Digital Subscriber Line (ADSL2+) provides high-bit-rate digital information over telephone subscriber lines. The TII 97C-1-1 splitter design makes it possible to use a single phone line to provide triple play services including ADSL2+ and IPTV.

INDUSTRY STANDARDS

- ANSI T1.413 compliant.
- Listed to UL 1863 as a communication circuit accessory.

TII 97C

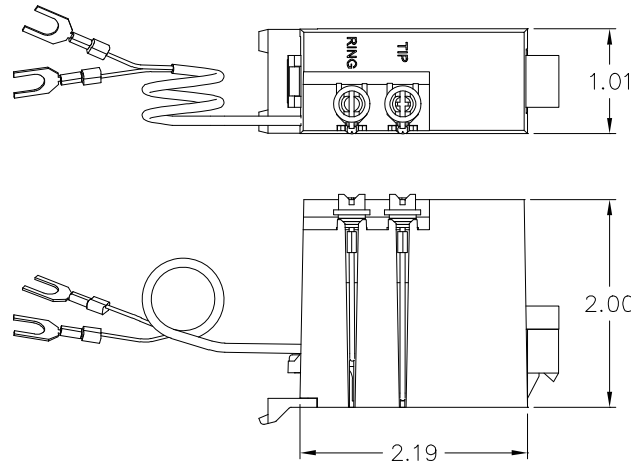

Dimensions are in Inches

SPECIFICATIONS

ELECTRICAL (Complies with ANSI T1.413 Issue 2 Annex E)

DC Loop Current	0 to 100 mA
DC Loop Voltage (tip-to-ring)	0 to -60Vdc
Ringing Signals	103 Vrms superimposed on the DC Loop Voltage; 20 to 30 Hz
DC Resistance	< 20 ohms, POTS tip-to-ring with Line port (U-R) shorted
Insertion Loss (Short & Long Loop)	≤ 0.5 dB
Tip-to-Ring Capacitance, POTS port	20 ≤ C ≤ 100 nF; 20 – 30 Hz
Input Impedance (Measured Level)	≤ 0.25 dB; 30 – 2200 kHz, ZTr = 600
Attenuation Distortion (Voice Band), increase relative to Insertion Loss at 1004 Hz	+0.7 to -0.5dB; 200 – 3.4 kHz, short loop, ZTc = 900, ZTr = 600 +0.7 to -0.5dB; 3.4 – 4.0 kHz, short loop, ZTc = 900, ZTr = 600 +0.4 to -0.5dB; 200 – 3.4 kHz, long loop, ZTc = 900, ZTr = 600 +0.5 to -0.5dB; 3.4 – 4.0 kHz, long loop, ZTc = 900, ZTr = 600

ENVIRONMENTAL

Lightning Surge	GR-1089-CORE Level 1 and Level 2 surge
Power Cross	GR-1089-CORE First and Second Level AC Power Fault Immunity
Operating Temperature	-40 to +65°C (-40 to 149°F)
Relative Humidity	0 to 95%, non-condensing
UL Listed	As a communication circuit accessory

ORDERING INFORMATION

Model No.	Description
TII 97C-1-1-2	ADSL2+ POTS Splitter Module, IPTV Compatible, with Screw Terminations and Spade Connectors
Standard Package:	50 pieces
Weight:	0.20 lbs. each

Customer Service (888) 844-4720 TOLL FREE • (631) 789-5020 • FAX: (631) 789-5063



E-MAIL: customer.service@tiinettech.com